

TDK Pot Core P 22/13-52H

Based on IEC publication 133 and JIS C 2516.

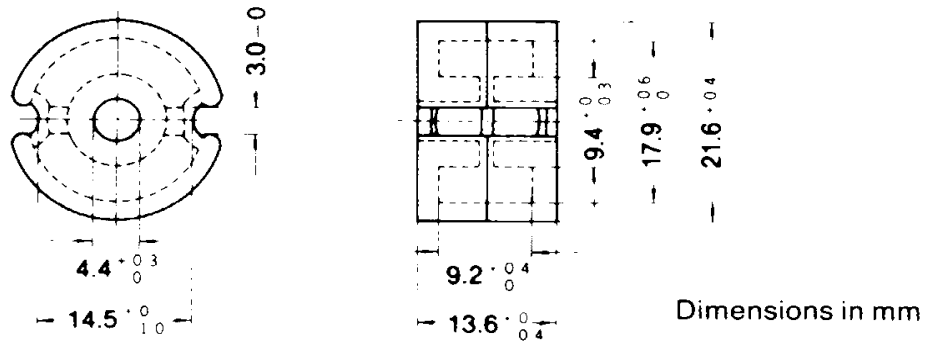

Parameter

Core factor	C_1	mm ³	0.497
Effective magnetic path length	ℓ_e	mm	31.5
Effective cross-section area	A_e	mm ²	63.4
Effective volume	V_e	mm ³	2000
Cross-sectional center pole area	A_{cp}	mm ²	51.6
Minimum cross-sectional area	$A_{cp \text{ min.}}$	mm ²	47.7
Cross-sectional winding area of core	A_{cw}	mm ²	42.1
Weight (approx.)		g	12.7

Ordering code	A_L -value (nH/N ²)	Effective permeability (μ_e)
	Tolerance	
Without air gap		
H5AP22/13Z-52H	5900 ± 25%	2333
H5C2P22/13Z-52H	19500 ± 30%	7712 (at 21.7 mT)
	16000 ^{+40%} / _{-30%}	6318 *(at 0.5 mT)
PC40P22/13Z-52H	2990 min.	1183 min.
With air gap		
PC40P22/13A100-52H	100	39.6
PC40P22/13A160-52H	160 ± 3%	63.5
PC40P22/13A250-52H	250	99.5

* Reference specification when 0.5mT is applied to cores.

Measuring conditions: Coil ϕ 0.35, 2UEW, 100Ts. Frequency 1kHz, level 0.5mA.