

ELT25/6.6 (combination of ELH25/4.3 & Plate) Core Series

STD AL VALUE

STD ITEM DESCRIPTION	AL-VALUE
PC95ELT25/6.6 - Z	8770 ± 25%
PC95ELT25/6.6 - A2430	2430 ± 15%
PC33ELT25/6.6 - Z	4750 ± 25%
PC33ELT25/6.6 - A100	100 ± 3%
PC33ELT25/6.6 - A160	160 ± 3%
PC33ELT25/6.6 - A250	250 ± 5%

Note) ELH/PLT combination

15.1 g / pr

Core parameters

C_1 (mm ⁻¹)	0.295
l_e (mm)	26.2
A_e (mm ²)	88.9
V_e (mm ³)	2329
A_{min} (mm ²)	83.2
A_{cw} (mm ²)	14.5

ELH25/4.3 core (Fig.1)

Sym.	DIMENSIONS (mm)		
	SPEC.	Min.	Max.
A	25.00 ± 0.45	24.55	25.45
B	4.29 ± 0.10	4.19	4.39
C	20.00 ± 0.35	19.65	20.35
D	2.0 ± 0.1	1.9	2.1
E	20.83 ± 0.35	20.48	21.18
F1	6.32 ± 0.15	6.17	6.47
F2	14.54 ± 0.25	14.29	14.79
R2	0.5 typ.		

PLT25/2.3/20 core (Fig.2)

Sym.	DIMENSIONS (mm)		
	SPEC.	Min.	Max.
A	25.00 ± 0.45	24.55	25.45
B	2.29 ± 0.10	2.19	2.39
C	20.00 ± 0.35	19.65	20.35

Core Shape & Nomenclature

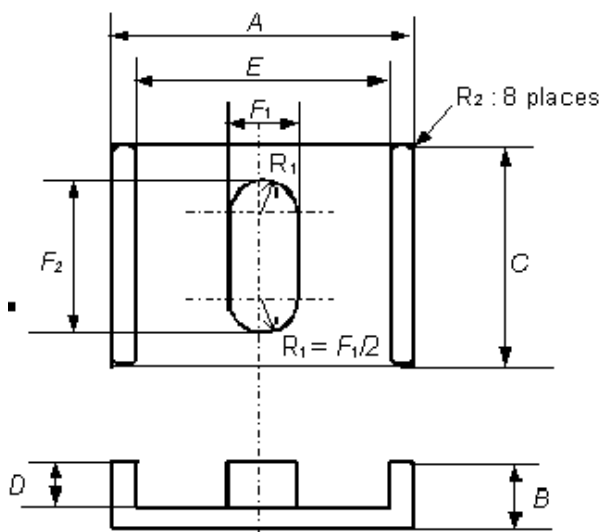

Fig.1 ELHcore

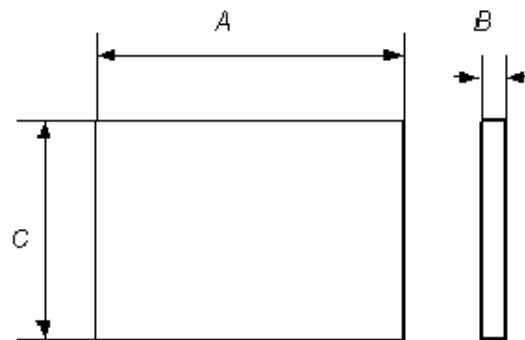

Fig.2 PLT core

TDK CORPORATION

MH&W International Corp, 14 Leighton Place, Mahwah, NJ 07430
Toll Free: 866-MHW-CORE, Email: salesm@mhw-intl.com