

ELT22/8 (combination of ELH22/6 & Plate) Core Series

STD AL VALUE

STD ITEM DESCRIPTION	AL-VALUE
PC95ELT22/8 - Z	6540 ± 25%
PC95ELT22/8 - A1850	1850 ± 15%
PC33ELT22/8 - Z	3510 ± 25%
PC33ELT22/8 - A100	100 ± 3%
PC33ELT22/8 - A160	160 ± 3%
PC33ELT22/8 - A250	250 ± 5%

Note) ELH/PLT combination

12.6 g / pr

Core parameters

C_1 (mm ⁻¹)	0.404
l_c (mm)	27.5
A_e (mm ²)	68.2
V_e (mm ³)	1876
A_{min} (mm ²)	64.4
A_{cw} (mm ²)	51.1

ELH22/6 core (Fig.1)

Sym.	DIMENSIONS (mm)		
	SPEC.	Min.	Max.
A	22.0 ± 0.4	21.6	22.4
B	6.02 ± 0.15	5.87	6.17
C	17.6 ± 0.3	17.3	17.9
D	4.00 ± 0.15	3.85	4.15
E	18.33 ± 0.35	17.98	18.68
F1	5.56 ± 0.15	5.41	5.71
F2	12.79 ± 0.25	12.54	13.04
R2	0.5 typ.		

PLT22/2/17.6 core (Fig.2)

Sym.	DIMENSIONS (mm)		
	SPEC.	Min.	Max.
A	22.0 ± 0.4	21.6	22.4
B	2.02 ± 0.10	1.92	2.12
C	17.6 ± 0.3	17.3	17.9

Core Shape & Nomenclature

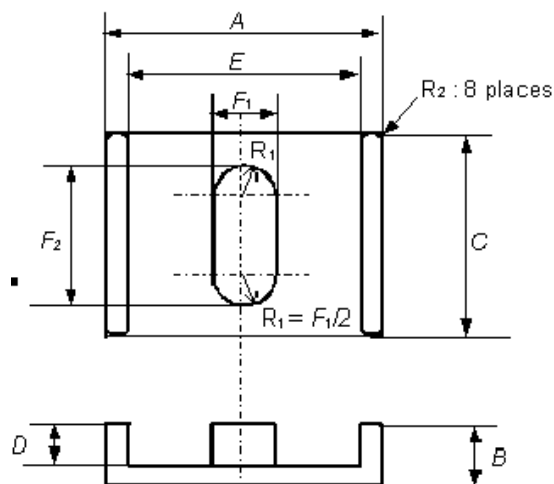

Fig.1 ELH core

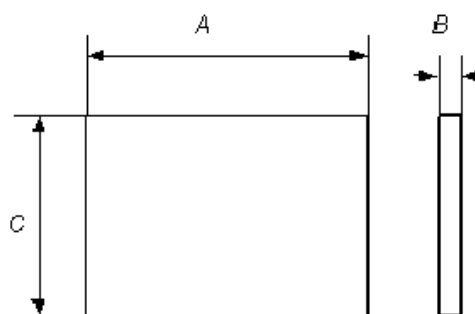

Fig.2 PLT core

TDK CORPORATION

MH&W International Corp, 14 Leighton Place, Mahwah, NJ 07430

Toll Free: 866-MHW-CORE, Email: salesm@mhw-intl.com