

ELT13/3.4 (combination of ELH13/2.2 & Plate) Core Series

STD AL VALUE

STD ITEM DESCRIPTION	AL-VALUE
PC95ELT13/3.4 - Z	3390 ± 25%
PC95ELT13/3.4 - A740	740 ± 15%
PC33ELT13/3.4 - Z	2090 ± 25%
PC33ELT13/3.4 - A63	63 ± 3%
PC33ELT13/3.4 - A100	100 ± 5%
PC33ELT13/3.4 - A160	160 ± 7%

Note) ELH/PLT combination

2.5 g / pr

Core parameters

C_1 (mm ⁻¹)	0.563
l_e (mm)	13.5
A_e (mm ²)	24.0
V_e (mm ³)	324
A_{min} (mm ²)	22.5
A_{cw} (mm ²)	3.77

ELH13/2.2 core (Fig.1)

Sym.	DIMENSIONS (mm)			
	SPEC.	Min.	Max.	
A	13.00 ± 0.25	12.75	13.25	
B	2.19 ± 0.1	2.09	2.29	
C	10.4 ± 0.2	10.2	10.6	
D	1.0 ± 0.1	0.9	1.1	
E	10.83 ± 0.2	10.63	11.03	
F1	3.29 ± 0.1	3.19	3.39	
F2	7.56 ± 0.15	7.41	7.71	
R2	0.3 typ.			

PLT13/1.2/10.4 core (Fig.2)

Sym.	DIMENSIONS (mm)			
	SPEC.	Min.	Max.	
A	13.00 ± 0.25	12.75	13.25	
B	1.19 ± 0.05	1.14	1.24	
C	10.4 ± 0.2	10.2	10.6	

Core Shape & Nomenclature

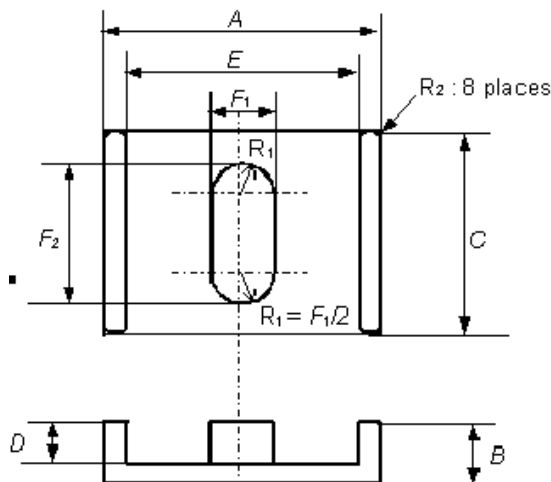

Fig.1 ELH core

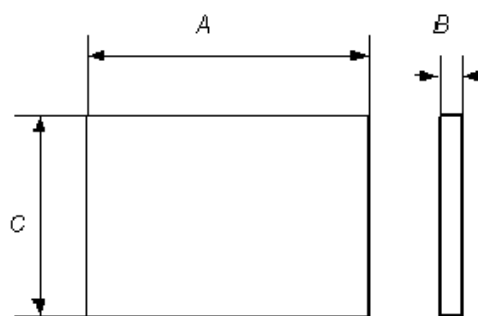

Fig.2 D core (Plate)

TDK CORPORATION

MH&W International Corp, 14 Leighton Place, Mahwah, NJ 07430
Toll Free: 866-MHW-CORE, Email: salesm@mhw-intl.com