

## EL13x4.4 (pair of ELH13x2.2) Core Series

### STD AL VALUE

STD ITEM DESCRIPTION	AL-VALUE
PC95EL13x4.4 - Z	3160 ± 25%
PC95EL13x4.4 - A720	720 ± 15%
PC33EL13x4.4 - Z	1890 ± 25%
PC33EL13x4.4 - A63	63 ± 3%
PC33EL13x4.4 - A100	100 ± 5%
PC33EL13x4.4 A160	160 ± 7%

Note) ELH/ELH combination

2.2 g / pr

### ELH13x2.2 core

Sym.	DIMENSIONS (mm)			
	SPEC.	Min.	Max.	
A	13.00 ± 0.25	12.75	13.25	
B	2.19 ± 0.1	2.09	2.29	
C	10.40 ± 0.2	10.20	10.60	
D	1.00 ± 0.1	0.90	1.10	
E	10.83 ± 0.2	10.63	11.03	
F1	3.29 ± 0.1	3.19	3.39	
F2	7.56 ± 0.15	7.41	7.71	
R2	0.30 typ.			

### Core parameters

$C_1$ (mm <sup>-1</sup> )	0.652
$l_e$ (mm)	15.5
$A_e$ (mm <sup>2</sup> )	23.8
$V_e$ (mm <sup>3</sup> )	369
$A_{min}$ (mm <sup>2</sup> )	22.5
$A_{cw}$ (mm <sup>2</sup> )	7.55

### Core Shape & Nomenclature

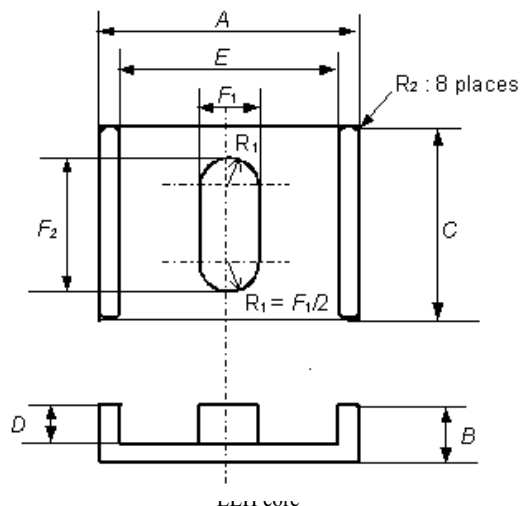

TDK CORPORATION

MH&W International Corp, 14 Leighton Place, Mahwah, NJ 07430  
 Toll Free: 866-MHW-CORE, Email: salesm@mhw-intl.com