

TDK EP Cores EP13

Based on JIS C 2516.

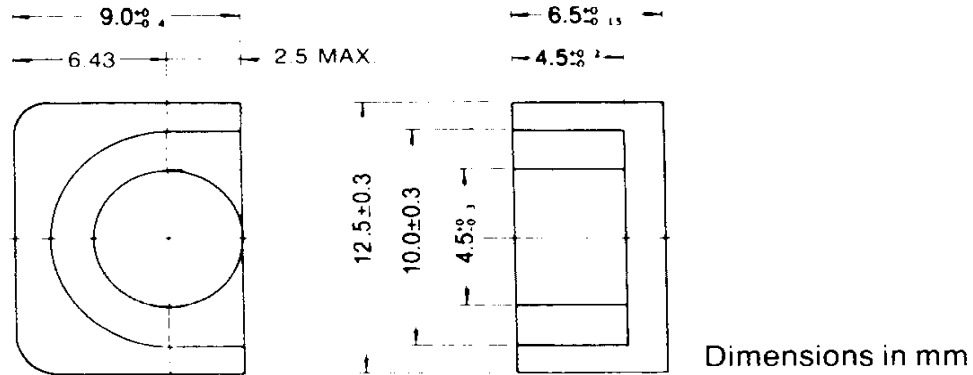

Parameter

Core factor	C_1	mm ⁻¹	1.24
Effective magnetic path length	l_e	mm	24.2
Effective cross-section area	A_e	mm ²	19.5
Effective volume	V_e	mm ³	472
Cross-sectional center pole area	A_{cp}	mm ²	14.9
Minimum cross-sectional area	$A_{cp \text{ min.}}$	mm ²	13.9
Cross-sectional winding area of core	A_{cw}	mm ²	13.0
Weight (approx.)		g	5.1

Ordering Code		Al-Value (nH/N ²) min.	Effective Permeability (μ_e)	
Without Air Gap				
H5AEP13-Z		1700	1677	
H5C2EP13-Z	Non-Standard	5000	4934	
H5C3EP13-Z		5600	5526	
H5C4EP13-Z	New Material	4650		25°C
		4650		-20°C
DN40EP13-Z	New Material			thd Material
PC40EP13-Z		1170	1155	
PC50EP13-Z		1100±25%	1085	
With Air Gap				
PC40EP13A100		100±5%	99	
PC40EP13A160		160±7%	158	
PC50EP13A100		100±5%	99	
PC50EP13A160		160±7%	158	

Measuring Conditions: N=100T, Frequency=1KHz, Level=0.5mA
H5C3/H5C4:100T, 10KHz, 10mV